



**DEADLINE 7 RESPONSE**  
**KENT DOWNS AONB RESPONSE TO**  
**National Highways Deadline 6 Submission**  
**Response to Action Point 6 from ISH 9**  
**9.157 Kent Downs AONB and Utilities Works**

**Interested party Ref no: 20035310**

The Action Points from ISH 9 Environment & Biodiversity included a requirement (No 6) for the Applicant to provide a Utilities Plan overlaying the extent of the ancient woodland proposed to be removed onto the location of the proposed utility diversions.

In response, the Applicant has provided a plan (Doc 9.157 [link](#)) that shows the AONB boundary, the extent of Ancient Woodland and the utilities diversions and alignments. It fails however to serve its intended purpose as it does not illustrate the proposed removal of any of the Ancient Woodland within the AONB.

The area of woodland proposed to be removed is provided in another of the Applicant's submission document, see Figure 1 below ( 6.2 Environmental Statement Figures Figure 7.24 - Tree Removal and Retention Plan [link](#)), however this does not have the utilities diversions overlaid. Furthermore, this plan does not appear to correspond with Figure 8.33 Ancient Woodland Impacts, Page 2 of 6 (Doc 6.2 Environmental Statement) [link](#)), - see Figure 2 below, which shows additional areas of Ancient Woodland to be lost to those shown on the Tree Removal Plan. In addition, the Environmental Masterplan Section 1, Sheet 3, [link](#) , relevant extract shown in Figure 3 below, shows proposed replacement planting (comprising species rich grassland and shrubs with intermittent trees) on the land currently comprising Ancient Woodland (and other woodland not designated as Ancient) to the immediate north of the A2 eastbound on slip from Brewers Road and the southern part of the land locked triangle to the east of The Nook Pet Hotel (Broughurst Cottage), that is not indicated as being removed on the Tree Removal and Retention Plan. These areas are circled in yellow/orange on Figures 1 to 3 below.

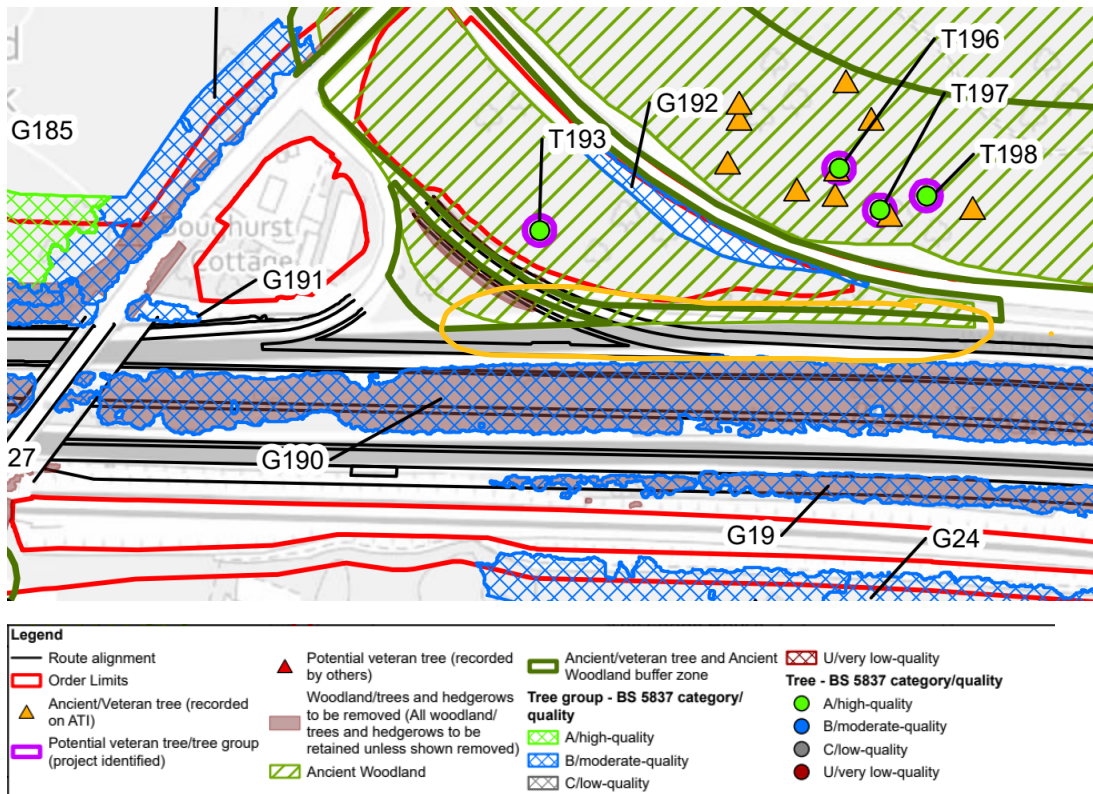

Figure 1 Tree Removal and Retention Plan, taken from 6.2 Environmental Statement Figures Figure 7.24.

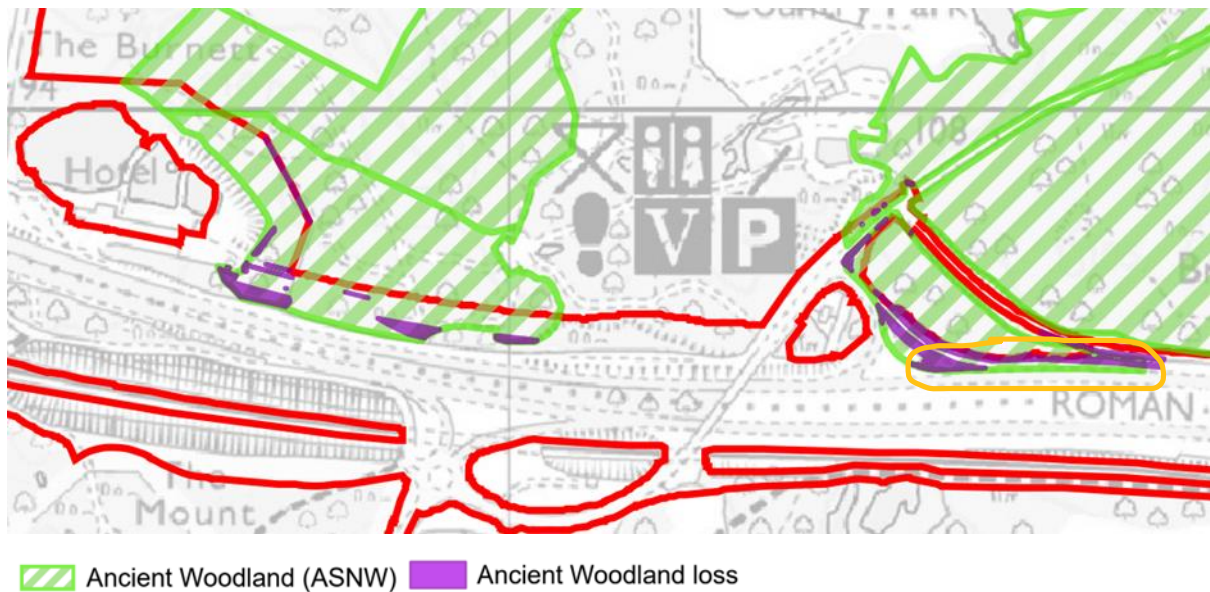

Figure 2 – Extract taken Environmental Statement, Figure 8.33 Ancient Woodland Impacts, Page 2 of 6)

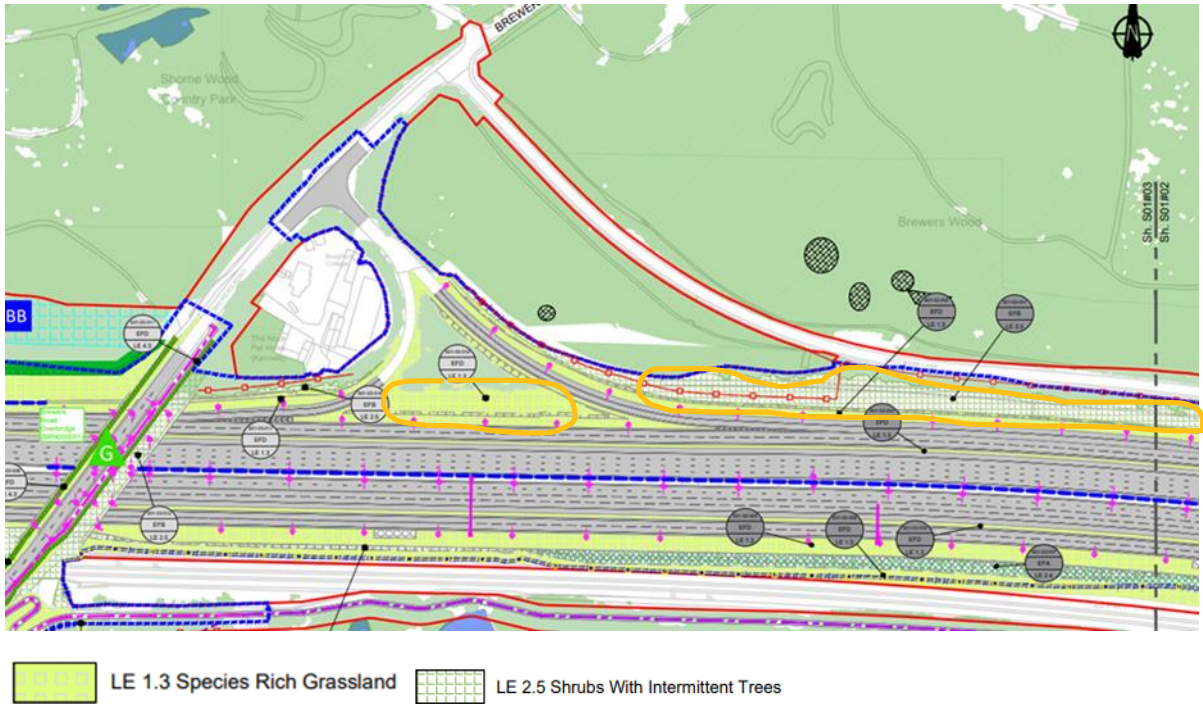
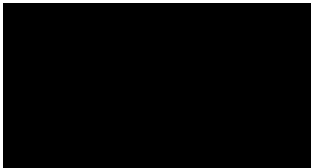

Figure 3 – extract from Environmental Masterplan Section 1, Sheet 3 with area of woodland to be removed circled in yellow)



Katie Miller  
 Planning Manager, Kent Downs AONB Unit

17 November 2023